

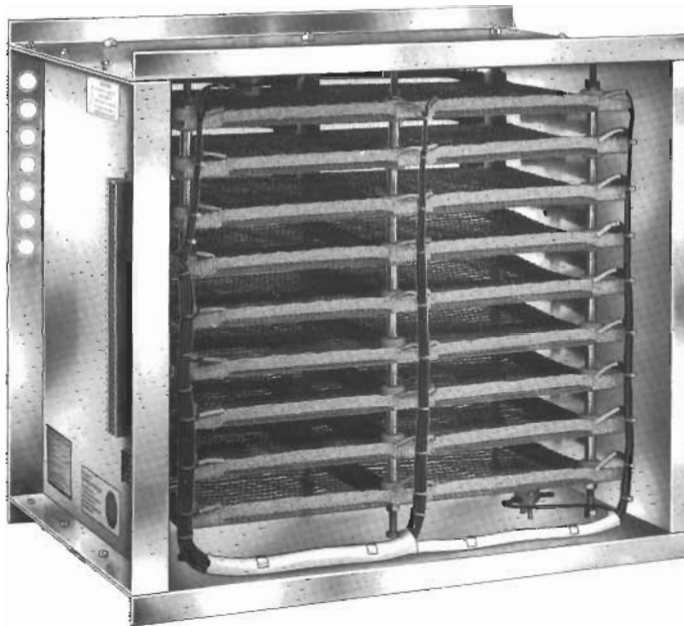

ENGELS - ELECTRIC AIR HEATERS Engelcompact® Type E-HR 6 for Unit Installation



as slide-in unit for ventilation and
air conditioning units

Technical Data Dimensions acc.

to customer specifications
(max. 2500 X 1800 mm, larger
cross-sections with combination
of several units)
as specified

Output:

0.25 - 750 kW in one unit
900 - 2,700,000 kJ
(215 - 645,000 kcal)

Operating voltage:

100 - 500 V (690 V on request)
alternating or rotary current

Switch groups:

as specified

Air outlet temperature:

depending on version up to max.
473 K (+ 200 °C)

Air flow rate:

approx. 1.0 - 10 m/s
(depending on version),
made to measure at least 2 - 3 m/s

Design:

standard with a temperature
monitor of
type ZB 01/363K (+ 90 °C).
Otherwise as described for E-HR 5,
but without terminal box.
All units equipped with genuine
Engels heating grids

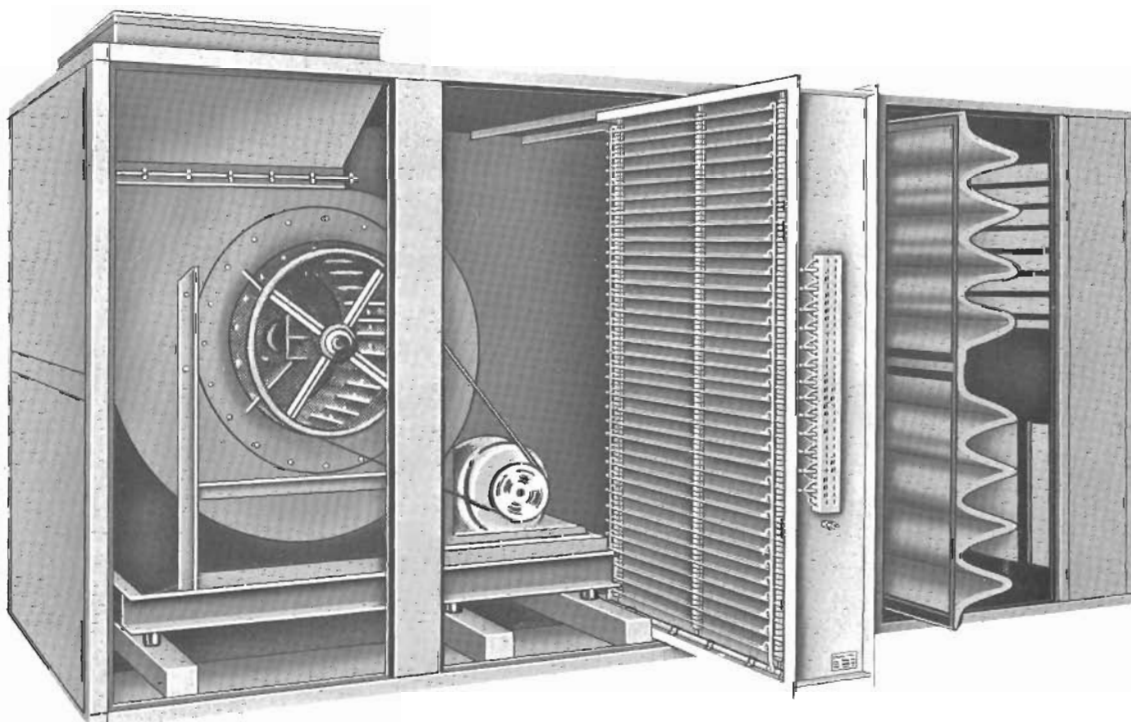

Installation also in vicinity of motor or filter



ENGELS - ELECTRIC AIR Heaters

Engelcompact® Type E-HR 6 for Unit Installation

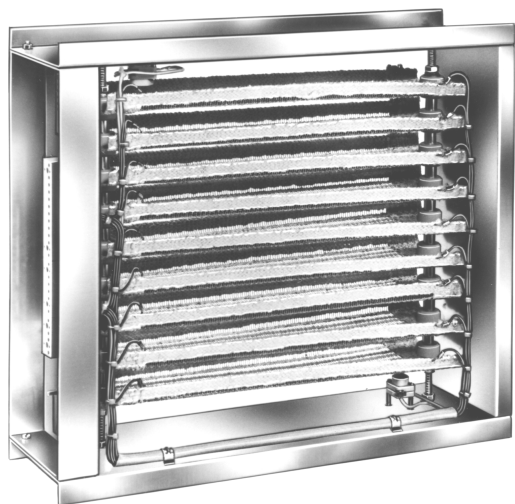

Installation elements for air heating units (AHU)

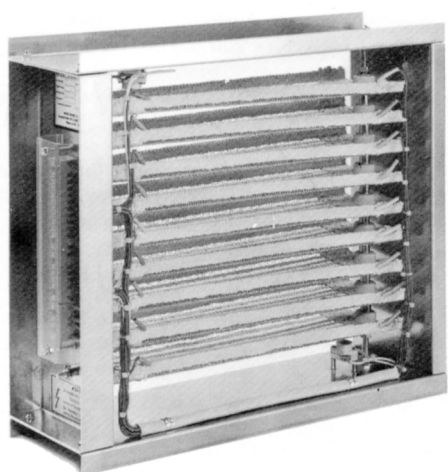

Installation element for ventilation units
with terminal strip cover

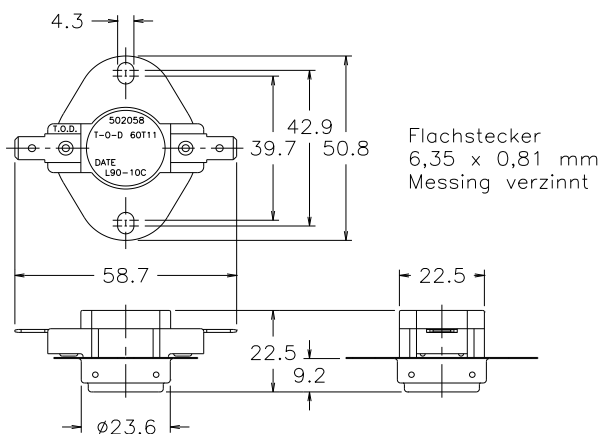

Engelcontrol® temperature monitor type ZB 01 / T75 or T90



Design

Standard aluminium frame made of aluminium ALMG 3, material no. 3.3535. The sheet metal thickness is 1.5 - 3.0 mm according to unit size.

Only genuine Engels heating grids® are used as installation elements. Wiring and electrical connection at a terminal strip attached on one side. Other versions can be considered on request. The further specification corresponds to type E-HR 5 or standard units (description p. 6).

A temperature monitor of type ZB 01 - 363 K is standard.

Terminal strip cover on request.

Installation

Easy installation as slide-in unit. Simple use even in motor or filter vicinity and in compact units and AC cabinets.

Can be installed independently of position. Safety temperature limiter and air flow monitor should be directly installed in the ventilation unit.

Note

As Engelcompact® air heaters of type E-HR 6 are made to measure, you can obtain precisely adjusted heat exchangers for electrical energy for your entire range of units.

Engelcompact® air heaters offer crucial advantages (see p. 7).

Always observe information bulletins no. S 20 and A - 1998.

Please use our dimensional sheets for inquiries or ordering.

Accessories

Temperature monitor type ZB 01, automatic - breaks contact at rising temperatures on request pre-set to 348 K / 363 K (+ 75° / + 90°C).

Technical data for type ZB 01

Design acc. to VDE 0631

Up to + 175°C high-temperature resistant resin housing.

Connections for flat plug 6.3 mm.

Contact: breaks with rising temperature
Nominal temperature difference: $\pm 10\%$ (°C)
Response temperature: see above
Nominal voltage: 250 V, 50-60 Hz
Breaking capacity: max. 10 A.